



## KEY INFORMATION 2024 FOR STUDENTS AND PARENTS

---

### OUR VISION

Marian College is a Catholic community with a love of faith, learning and service for the common good.

Ko te Kāreti o Marian he hāpori Katorika e aroha ana ki te whakapono, ki te mātauranga, ki te rato mō te wairua pai o te tangata.

### OUR MISSION

To empower young women to be confident, committed, faith-filled learners, enabling them to fulfil their potential and to contribute to the common good of society.

Mā mātou ngā taitamāhine e whakamana kia tū māia, kia tū manawanui, kia tū ngākau pono i te akoranga hei whakakaha i tō rātou pito mata, ā, mā rātou anō e whakarawe ana ki te wairua pai o te pāpori whānui

### OUR VALUES

Courage, Kia māia, Lototele  
Commitment, Kia ū, A'afiaga  
Perseverance, Kia manawanui, Onosai i mea tiga  
Respect, Whakaute, Fa'aaloalo

Marian College follows the Gospel of Jesus Christ. The **courage, commitment** and **perseverance** attributed to Mary, the Mother of God, are modelled by both St Mary of the Cross Mackillop, foundress of the Sisters of St Joseph and the Venerable Catherine McAuley, foundress of the Sisters of Mercy. The charisms of these two religious orders guide the spiritual life of our college.

At Marian, we also foster New Zealand curriculum values - **respect** for self, others, and the environment, as well as **community** and **participation** for the common good.

### OUR MOTTO

**Tātou ko Mere e whakapono ana – With Mary in faith**

This Marian College motto reflects the example that Mary, the Mother of God, provides to all of us. As the mother of Jesus Christ, Mary will provide you with an excellent example of faith in action, trusting in God's will, personal courage and family loyalty.

**Kia ngākau pono mō tō mātou wāheke – With faith in our future**

More recently, Marian College has adopted an additional motto which reflects our confidence in an exciting future for Marian College.

Waitangi Day observed  
Easter Friday  
Easter Monday  
All schools closed  
**Term 1 ends**

ANZAC day  
**Term 2 begins**  
King's Birthday  
Matariki  
**Term 2 ends**

**Term 3 begins**  
Mid term break  
**Term 3 ends**

**Term 4 begins**  
Labour Day  
Show Day  
**Term 4 ends (Yr 9 & 10)**

Teacher only days

Tuesday 6 February  
Friday 29 March  
Monday 2 April  
Tuesday 3 April  
Friday 12 April

Thursday 25 April  
Monday 29 April  
Monday 3 June  
Friday 28 June  
Friday 5 July

Monday 22 July  
Monday 12 September TBC  
Friday 27 September

Monday 14 October  
Monday 28 October  
Friday 15 November  
Thursday 12 December TBC

TBC

DAILY TIMETABLE 2024

	Monday	Tuesday	Wednesday	Thursday	Friday
1	8.30 - 9.30 60m	8.30 - 9.25 55m	8.50 - 9.45 55m	8.30 - 9.25 55m	8.30 - 9.30 60m
2	9.30 - 10.30 60m	9.25 - 10.15 50m	9.45 - 10.40 55m	9.25 - 10.15 50m	9.30 - 10.30 60m
House Group		10.15 - 10.35 House Group		10.15 - 10.35 House Group	
Interval	10.30 - 10.50 20m	10.35 - 10.55 20m	10.40 - 11.00 20m	10.35 - 10.55 20m	10.30 - 10.50 20m
3	10.50 - 11.45 55m	10.55 - 11.45 50m	11.00 - 11.55 55m	10.55 - 11.45 50m	10.50 - 11.45 55m
4	11.45 - 12.40 55m	11.45 - 12.35 50m	11.55 - 12.55 60m	11.45 - 12.35 50m	11.45 - 12.40 55m
Assembly/ House Group	12.40 - 1.15 Assembly				12.40 - 1.00 House Group
Lunch	1.15 - 2.00 45M	12.35 - 1.20 45m	12.55 - 1.35 40m	12.35 - 1.20 45m	1.00 - 1.40 40m
5	2.00 - 3.00 60m	1.20 - 2.10 50m	1.35 - 2.30 55m	1.20 - 2.10 50m	1.40 - 2.40 60m
6		2.10 - 3.00 50m		2.10 - 3.00 50m	

## MARIAN COLLEGE PRAYER

---

*E te Atua o te aroha, God of love.*

*You are the reason we are here together,  
and together we want to live a life worthy of the Gospel.*

*We thank you for the gift of the Marian whānau and wider community.*

*We ask you to bless and protect the students and staff of Marian College.*

*Lord, fill us with your peace, so that when we journey onward, we can share your  
love and grace with others.*

*Help us to come together to serve our community in the Marian Spirit.*

*Mary Mother of God - pray for us*

*St Joseph - pray for us*

*St Mary of the Cross MacKillop - pray for us*

*Venerable Catherine McAuley - pray for us*

*Āmene.*

## STUDENT EXPECTATIONS

---

### OUR PHILOSOPHY

At Marian College we are a family, and this is linked to our Catholic beliefs and gospel values. As a result of this all students and staff show respect for each other. High standards of behaviour are expected at all times to demonstrate this.

### MARIAN COLLEGE STUDENTS ARE EXPECTED TO:

Treat everyone with respect

Take care of our school community, its equipment and the environment

Aim high in academic, sporting and cultural areas

Be a positive role model for Marian College

### MARIAN COLLEGE STUDENTS ARE REQUIRED TO:

- Respect and engage with the Special Character of the school
- Attend and participate in the College and associated events
- Respect themselves and others by using appropriate language
- Wear the correct uniform at all times (see uniform page for further details)
- Arrive at school and all classes on time
- Follow classroom rules: follow the teacher's instructions promptly, be prepared and ready to work
- Threats or bullying including text or cyberbullying are not acceptable
- Illegal activities are not acceptable at any time. This includes possessing, using and/or supplying alcohol, drugs, smoking, vaping and weapons
- Physical and verbal aggression is not acceptable under any circumstances
- Ensure all litter is picked up from around the school

## THE SPECIAL CHARACTER OF MARIAN COLLEGE

*Marian College walks in the Gospel footsteps of two strong traditions in the Catholic church: The Mercy Tradition and The Josephite Tradition.*

---

### THE MERCY TRADITION

Catherine McAuley founded the Sisters of Mercy in Baggot Street, Dublin in 1827 to work with women and girls in need. From there the sisters spread out all over the world. The Mercy tradition has always promoted the works of mercy, both spiritual and corporal. The corporal works of mercy are to: feed the hungry; give drink to the thirsty; clothe the naked; shelter the homeless; visit the sick; free the captive; and bury the dead. The spiritual works of mercy are to: instruct the ignorant; counsel the doubtful; warn sinners; bear wrongs patiently; forgive offences willingly; comfort the afflicted; and pray for the living and the dead. The sisters ran St Mary's College in Christchurch founded in 1894 that in 1982 merged with another school to become Marian College.

### THE JOSEPHITE TRADITION

Mary MacKillop, a young woman of immigrant parents, with the help of Father Julian Tenison Woods, established the Sisters of St Joseph of the Sacred Heart in Penola, South Australia, in 1866. The main work of the sisters was the education of children and young people in country areas and later in the cities who would otherwise have no chance of an education. The Josephites emphasised 'making room for all', 'doing your bit', 'listening to God's call' and 'an attitude of gratitude'. In time the sisters spread to New Zealand. One of their schools was McKillop College in Christchurch founded in 1972, which later merged with St Mary's College to become Marian College.

### THE NAMING OF MARIAN COLLEGE AND FEAST DAY

Marian College is named after Mary, the Mother of God for two main reasons. This links to St Mary's College that had been named after Mary, the Mother of God. Also, Mary MacKillop had a special respect for Mary, the Mother of God. Because Marian College is named after Mary, our celebration day is on or close to 15 August, the Feast of the Assumption of Mary into heaven. This is also the national feast day for Catholics in New Zealand.

### THE COLLEGE CREST AND MOTTO

The College crest is an 'M' with a coronet, the symbol for Mary, the Mother of God. Our motto is 'With Mary in faith', 'Tātou ko Mere e whakapono ana', which shows that the aim of the College is to help students be educated in a spirit of faith as Mary had, to become Catholic women who will influence society for good. The religious education programme and religious life of the college are two of the many ways we work towards fulfilling these ideals.

### MERCY & JOSEPHITE TRADITIONS

At Marian College, in keeping with both the Mercy and Josephite traditions, we have an emphasis on the following:

- Mary, the Mother of God, Mary MacKillop and Catherine McAuley who are models pointing to Christ
- Gospel values of courage, commitment, and perseverance that were shown by all three of these women
- Service to those in need, as modelled by Mary MacKillop, Catherine McAuley and Jesus himself
- The place of the Cross, of hardship and challenge in one's life
- The importance of prayer
- Having a close-knit community spirit within our school
- The rounded human development of each person

GROUND FLOOR DIRECTORY

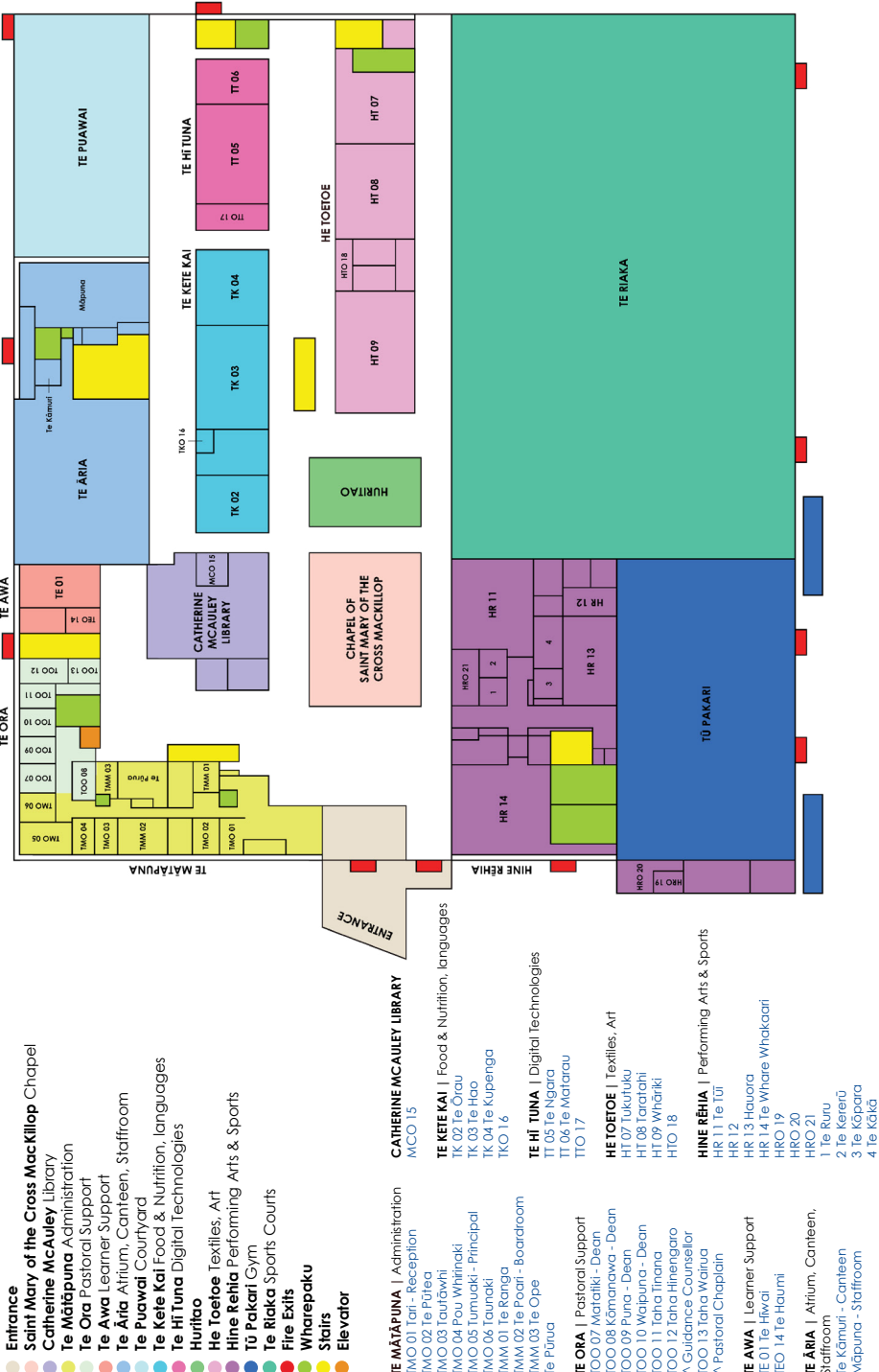

FIRST FLOOR DIRECTORY

- Aroha English, Religious Studies
- Matariki Religious Studies, Social Science, Careers
- Tātai Whetū Mathematics
- Te Taiāo Science
- Hine Rēhia Gallery Seating
- Wharepaku
- Stairs
- Elevator

**AROHA** | English, Religious Studies  
AR 16 Kia Māia  
AR 17 Kia Ū  
AR 18 Kia Manawanui  
AR 19 Ihakaure  
AR 20 Arawhai  
ARO 22  
ARO 23

**MATARIKI** | Religious Studies, Social Science, Careers  
MA 21 Wai-orangi  
MA 22 Uirangi  
MA 23 Whapuna-ā-rangi  
MA 24 Hālerangi  
MA 25 Pāhukawa  
MA 26 Tupurangi  
MA 27 Wāiti  
MAO 24  
MAO 25 Tupuānuku

**TĀTAI WHETŪ** | Mathematics  
TW 28 Awhiroa  
TW 29 Hīnāroa  
TWO 26

**TE TAIĀO** | Science  
TA 30 Te Ao Tūroa  
TA 31 Ō Kōwekawe  
TA 32 Ahupūngao  
TAO 27

**HINE RĒHIA** | Sports  
Gallery Seating

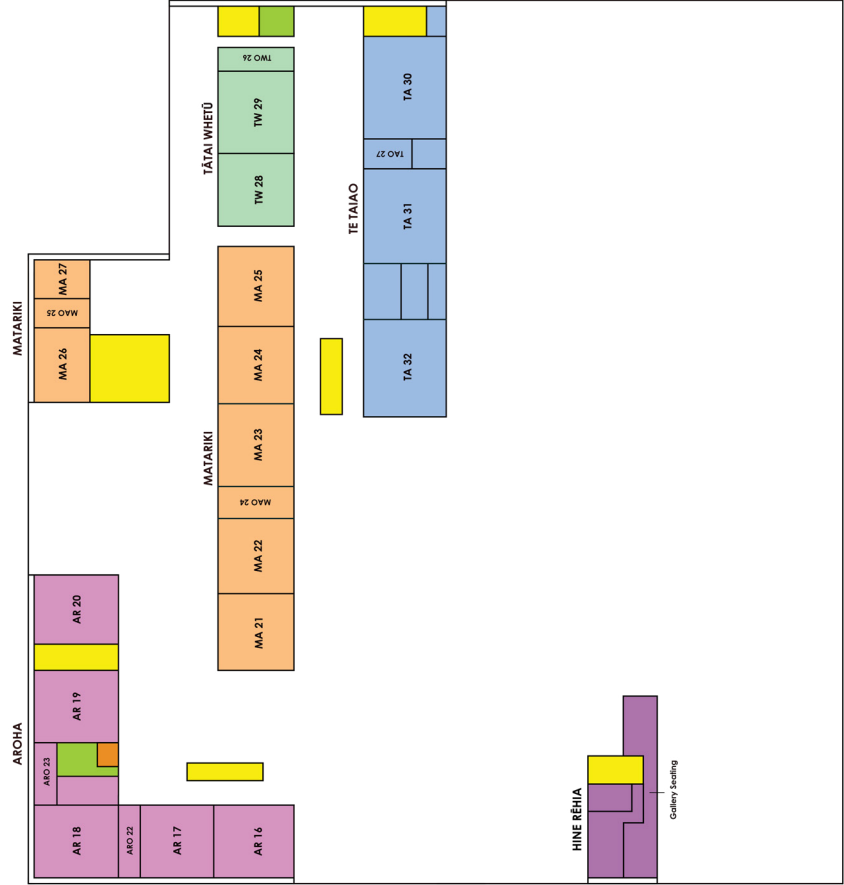

# A Marian College Graduate

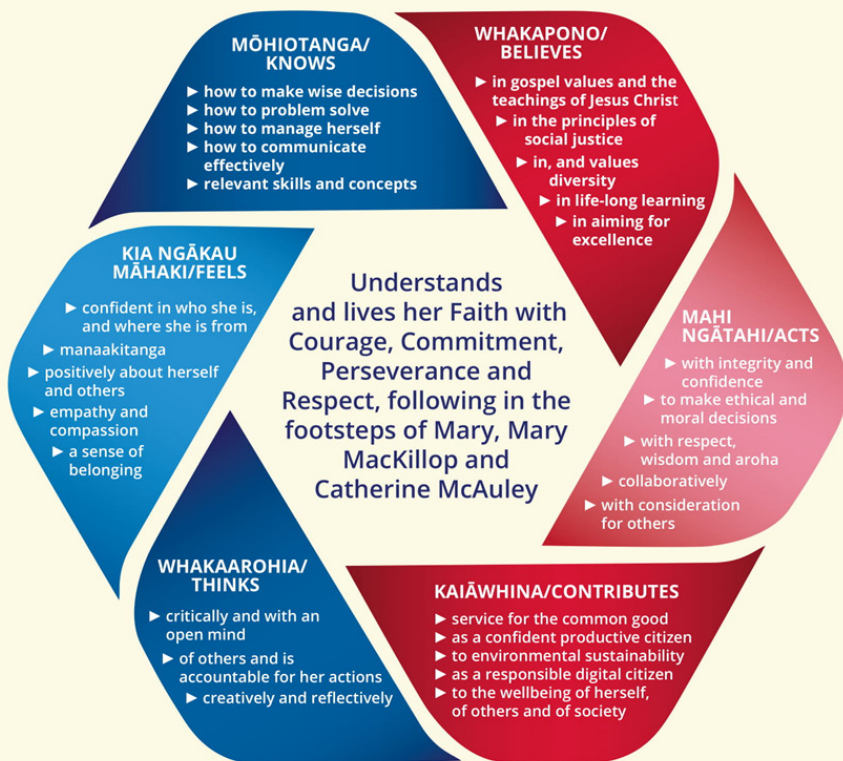



## MARIAN COLLEGE UNIFORM

---

Full and correct school uniform is to be worn to, from and at school. The blazer must be worn on all official occasions and at all times on the street. Hair is to be worn simply and either cut above the collar level, or neatly tied back with red or royal-blue ribbons, hair ties or hairbands. Makeup is not permitted with the school uniform and only clear nail polish is permitted. Girls with pierced ears may wear two small plain gold or silver studs. No other piercings are permitted; clear retainers can be worn in place of any piercings. If unable to be seen, Taonga may be worn with the uniform. Students who, for unforeseen circumstances, are unable to wear the correct uniform must obtain a uniform pass from the Deputy Principal.

### ARTICLES REQUIRED THROUGHOUT THE YEAR

1. Royal blue blazer with the school crest
2. Plain royal blue regulation cardigan or jersey
3. Brown lace-up or T-bar shoes or Roman sandals (socks optional with sandals)

### ARTICLES REQUIRED FOR SUMMER UNIFORM

1. Regulation blue dress
2. Short ankle length plain white socks with no logos

### ARTICLES REQUIRED FOR WINTER UNIFORM

1. Regulation kilt
2. White blouse with long sleeves and Marian College logo
3. Tie - Red for juniors or senior tie
4. Navy-blue tights or navy knee length socks (not black or ankle socks)
5. Regulation scarf (to be worn only in winter and must be removed indoors)

### ARTICLES REQUIRED FOR PHYSICAL EDUCATION

1. Regulation physical education shorts
2. Regulation physical education top

### ARTICLES REQUIRED FOR SPORT

1. Regulation sports jacket (optional)
2. Plain navy trackpants (optional)

**SPORTS** | Girls playing for school teams wear the physical education uniform unless they are issued with a team sport uniform. Correct sport uniforms (tracksuit) may be worn on a Wednesday if a student is going to play sport immediately after school. Jandals are not permitted and only navy tops with the Marian logo are to be worn underneath jackets.

**WET WEATHER** | In wet weather girls are expected to come to school adequately clad. A raincoat or puffer jacket may be worn but not during class time (The blazer is to be worn at all times).

**CYCLISTS** | Cyclists may wear the school tracksuit and change when they get to school. Students are encouraged to wear high vis vests.

**UNIFORM SUPPLIER** | Mainland Uniforms: 511 Wairakei Road and 189 Peterborough Street or online at [www.mainlanduniforms.co.nz](http://www.mainlanduniforms.co.nz)

*All articles of uniform must be clearly named. Questions on uniform are to be directed to the Deputy Principal.*

## COLLEGE INFORMATION

---

**ATTENDANCE** | Students are expected to be at school before the first bell and during the day they may not leave the college grounds without permission. Students cannot sign out without written or verbal permission from a parent. If unwell, students are not to ring their parents but are to go to the office.

**CANTEEN HOURS** | Interval and lunchtime.

**CELL PHONES AND EAR BUDS** | We are a phone free school.

**COSMETICS AND JEWELLERY** | Cosmetics and jewellery are not permitted with the school uniform except for girls with pierced ears who may wear two small plain gold or silver stud in each ear lobe. A watch may be worn.

**COLOURS** | Colours are awarded for sport, culture, special character and academia. Criteria can be found on the Marian College website.

**CULTURAL ACTIVITIES** | There are a wide range of activities to be involved in such as: choirs, drama, theatre-sports, musical groups, Kapa Haka, Pasifika culture groups etc.

### **EMERGENCY DRILLS | CONTINUOUS BELL RINGING**

1. Walk calmly in single file in silence to the assembly point on the school field (as stated on the notice by the door).
  2. Line up in Wā Whānau in year levels.
  3. In case of a severe earthquake, stay in your room, move away from windows, and shelter underneath a desk until told to move - **"Drop, Cover and Hold"**
  4. Do not re-enter the buildings until told all is clear.
  5. Lock down alarm (three short, three long, three short rings on bell), keep out of view on floor away from windows.
- 

**WĀ WHĀNAU** | There are four houses at Marian, with six vertical form classes contained in each.

**BRODIE (KIKORANGI)** is named after one of the first Catholic Bishops of Christchurch.

**DEANS (KĀKĀRIKI)** is named after an early Canterbury family with their historical family home at Deans Bush in Christchurch.

**SEYMOUR (KŌWHAI)** is named after one of the first four ships to bring settlers to Canterbury, the "Sir George Seymour".

**TAKAHE (WHERO)** is named after a native bird which used to roam freely on the Canterbury plains.

---

**LAPTOPS, IT** | Year 9, 10 and 11 students to follow BYOD guidelines and must have their own device. Years 12 and 13 are encouraged to bring their own device to school.

**LEADERSHIP** | The following groups operate providing leadership opportunities for students: Student Executive, Culture Council, House Council, Health Council, Sports' Council, Student Trustee Council, Environment Committee, and Special Character Committee.

**LIBRARY HOURS** | The college library is open from 8.00 a.m. to 3.30 p.m. daily except for 15 minutes during the lunch break (12.00 – 12.15 p.m.)

**MEDIA AND INTERNET** | Students are reminded that only the Board Chairperson and the Principal have the right and responsibility to speak to the media or to publish electronically or otherwise anything, including photos and video clips, that identify Marian College or its students, staff and community members.

**OFFICE HOURS** | The college office is open between 8.00 a.m. and 4.00 p.m. each school day. Messages may be left for teachers between these hours. Students should generally go to the office before or after school, at interval or lunch time.

**ONLINE** | The school website [www.mariancollege.school.nz](http://www.mariancollege.school.nz) is where you can find latest Marian news, school newsletters and information. The Marian College sport website [www.sporty.co.nz/ariancollege](http://www.sporty.co.nz/ariancollege) allows access to sports draws, results, online registrations and more. Follow Marian on Facebook [@ariancollegech](https://www.facebook.com/ariancollegech) and [@MarianSpecialCharacter](https://www.facebook.com/MarianSpecialCharacter) and on Instagram [@arian\\_college\\_sport](https://www.instagram.com/arian_college_sport) and on [@ariancollegech](https://www.instagram.com/ariancollegech). The Marian College mobile app gives access to the school portal and is available on the App Store and on Google Play. This can also be used to report absences.

**MY MAHI** | A computer APP where students record service, check timetables, results etc.

**PORTAL** | To access the portal go to: [Web.kamar.mariancollege.school.nz](http://Web.kamar.mariancollege.school.nz) or the Marian College website [www.mariancollege.school.nz](http://www.mariancollege.school.nz) and click on student portal. Logins and passwords are issued to new students (and parents) during the first week at school.

The portal is where students will find:

**Details:** Personal details, Timetable, Attendance Information, Groups.

**Results:** Current year's results (real time reporting), Class Effort (Weekly Engagement Reports), EOY House Group Summary, Awards and NCEA Summary (Senior Students).

**SERVICE ACTIVITIES** | Every Marian student is required to complete six hours service within the school and/or community each year. This is reported on each year in student reports to parents. See your Wā Whānau teacher for details.

**SPORTS** | At Marian College you can take part in such sports as netball, indoor netball, basketball, touch rugby, rugby, football, futsal, hockey, korfball, badminton, cricket, tennis, water polo, swimming, athletics, equestrian, rowing, aerobics, korfball and kio o rahi. See Head of Sport for details.

**STATIONERY** | Additional basic items may be purchased from the office before school (8.00 – 8.25 a.m.), at interval, lunch time and from 3.00 – 4.00 p.m. each day, not during or between class time or at house group time.

**UNIFORM** | Full and correct school uniform is to be worn to, from and at school. All articles of uniform must be clearly named.

**VALUABLES AND MONEY** | Should be handed into the office before school for safe keeping.

## WHAT TO DO IF

You are late for school	If you arrive after the "starting" bell go to the office to sign in and collect a pass to give to your teacher. Lateness is to be explained by a parent replying to absence text, an email, or a phone call.
When you are absent from school	In the morning a parent/guardian phones the college on 3858449, emails <a href="mailto:exec@mariancollege.school.nz">exec@mariancollege.school.nz</a> or submits an APP notification with the reason for the absence.
You know that you are going to be absent	Bring a note signed by a parent/guardian, or email the office, stating when you will be absent and the reason for your absence.
You need to leave school during the day (for an appointment etc)	Parent/guardian to send a note, email or phone stating the time you will be leaving school and the reason for your absence. Before leaving go to the office to sign out and collect a pass.
You are going to have a pre-planned long term absence e.g. travel, surgery etc	Letter signed by a parent/guardian, or an email, must be sent to school addressed to the principal stating when and why you will be absent.
You have been absent from school for one or more periods	After period 1 and at the end of each day texts are sent home advising of absence – parents/guardians are to text, email or phone back with a reply.
You are going to be absent and will miss an assessment	Talk to your teacher beforehand. Senior students are to collect an extension form from the school office.
You have been absent from school and missed an assessment	Have a parent ring in, or email, if you are sick. Get an "Extension Request" form from the office and talk to your teacher.
You don't have the correct school uniform	Bring a note from a parent or guardian and hand to the Deputy Principal or Dean before school for a uniform pass.
You change your address, phone number or email	Inform the office immediately. Parents can also change details via the Marian College portal.
You are feeling ill or have an injury	GO TO THE OFFICE. If you need to go home the office will telephone to make arrangements for you.
You have lost something that belongs to you	Check where you have been during the day. Check lost property bin kept at the office.
You have a phone/electronics or jewellery confiscated	Phones can be collected from the office at the end of the day (1st confiscation). For a 2nd confiscation the item is to be handed into the office each day for a week and for a 3rd confiscation a parent is to collect phone from the office and phone to be handed in every day until the end of term. Jewellery can be collected from the office at the end of term.
You are being bullied or harassed	Tell the person, "Stop that. We don't do that here". Or talk to a Year 13 student, your peer support leader, Wā Whānau teacher, a teacher, the counsellor (see below to make an counsellor appointment), Dean, pastoral chaplain or your parents. Appointment request forms to see your Dean are near the sickbay.
You have been text bullied	Report it to the police and your mobile phone provider. Inform your parents. See your dean if this is affecting your relationships at school.
You have been internet bullied	Inform your parents. See your dean if this is affecting your relationships at school or contact Netsafe.
Making a Guidance Counsellor appointment	Go to: <a href="http://www.schoolinterviews.co.nz">www.schoolinterviews.co.nz</a> event code: 2dv4r

## WHO DO I SEE ABOUT

---

Accidents	School Office
Careers & Transition To Work	Mrs Blackwell
Distance Learning Students	DP in charge of curriculum   Ms Spencer
Deans - Kai Tautoka	Junior Dean   Ms Vousden
	Senior Dean   Ms Kelly
	Senior Dean   Mrs Fidow
	Senior Dean   Mrs Grocott
	DP in charge of curriculum   Ms Spencer
Examinations NCEA	Mrs Moody
Financial Matters	Office
First Aid	Sally Cummings
Guidance Counsellor	Deputy Principals   Mrs Parkin & Ms Spencer
Health & Safety Issues	Miss Dick
Wā Whānau Activities	Mrs Neilson
Library	Ms Vousden (Junior Dean)
Lockers	School Office
Late Passes	Office
Lost Property	Office
Leave Passes	Mrs Elliot
Musical Groups	Sharon Gardner
Pastoral Chaplain	Mrs Lawson, Mrs Bennie
Sports	Office
Stationery	Deputy Principals or Dean
Uniform Pass	Office (A charge will be made for replacement cards)
ID Cards	

## CYBERSAFETY | Student Responsible Use

---

Marian College believes in a Digital Citizenship model for supporting safe and responsible use of the internet in teaching and learning. An important part of this is that we are able to show others what that responsible use looks like while we are using technology in our learning.

We think a good digital citizen is someone who:

- Is a confident and capable user of ICT
- Will use digital technologies for learning as well as other activities
- Will think carefully about whether the information they see online is true
- Will be able to speak the language of digital technologies
- Understands they may experience problems when using technology, but can deal with them
- Will always use digital technologies to communicate with others in positive ways
- Will be honest and fair in all of their actions using digital technologies
- Will always respect people's privacy and freedom of speech online
- Will be digitally literate and help others to become a better digital citizen

We know this is important for us all, we ask everyone, the staff, students and volunteers working at the school to agree to use the internet and other technologies in a safe and responsible way by following the rules laid out in the Responsible Use Agreement.

If someone cannot agree to act responsibly, or the things that they do mean that other people are being harmed, then we might stop them from using the internet or other technology at school.